

Heavy & Medium Duty Trucks & Trailers

MVP

Precision-Engineered Fluid Power Products

The Sensible Choice for Pump/Valve Assembly



Dump Trucks
Dump Trailers

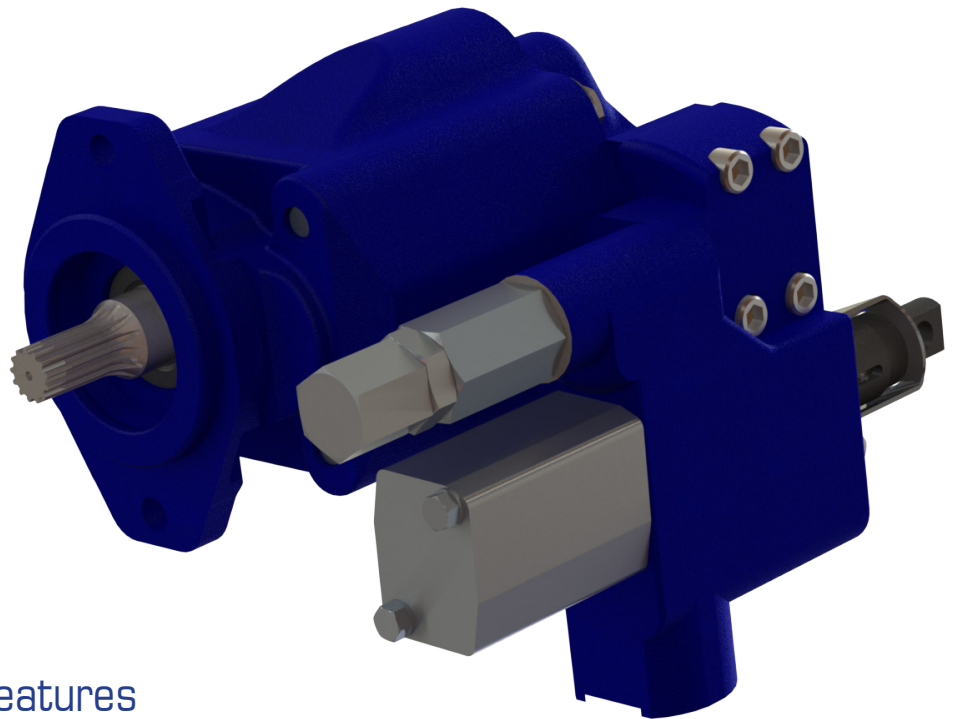
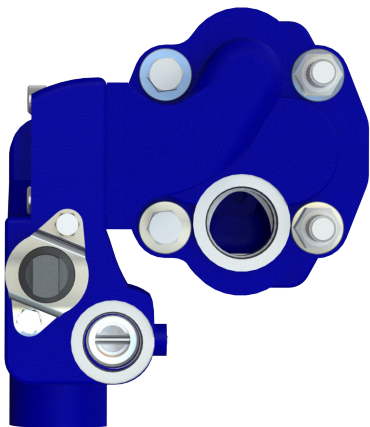

Features

- New concept of modular components fits Allison 4000 series transmission systems on Kenworth, Mack, Peterbilt, & Western Star.
- Pump and cylinder protected in the "Raise" and "Neutral" position of the spool.
- Built-in load check maintains dump body angle and is installed in the cylinder port for superior self-cleaning.
- Reduced weight.
- Built-in direct acting relief valve set at factory.
- 100% factory tested
- Flows of 37 and 46 GPM at 1800 RPM
- Pressures to 2500 PSI
- Speeds to 2400 RPM
- High strength alloy steel gear and shaft set.
- 3 line for continuous duty systems.
- 2 extra long studs for easy installation of pump support bracket on direct mount.
- Pressure balanced wear plates maintain high pump efficiency throughout all operating ranges.
- Valve Body is separate from pump.
- 2.5" Gear Produces 6.4 cubic inches of displacement. This means a higher PTO ratio is not required.





Pump/Valve Assembly

MVP-M24-0-0-ZA20-54-25-LCS

Most Valuable Pump

M - Motor, Shaft Seal

P - Pump, Shaft Seal

24 - Type II SAE B 2 & 4 Bolt Mount

31 - Type I SAE B 4 Bolt Mount

85 - Type II SAE B 2 Bolt Mount

86 - Type I SAE B 2 Bolt Mount

90 - Type I SAE B 2 & 4 Bolt Mount

0 - CW Rotation

1 - CCW Rotation

0 - Tipping Valve

X - No Tipping Valve

***Customer must provide pressure relief settings.**

LCS - Load Check Spring

Blank - w/out Load Check Spring

25 - 2500 PSI Relief Valve

Blank - without Tipping Valve

Shaft: SAE B 13 Tooth Splined

14 - Type I

54 - Type II

ZA20 - 2" Gear Width

ZA25 - 2.5" Gear Width



Mack - Granite

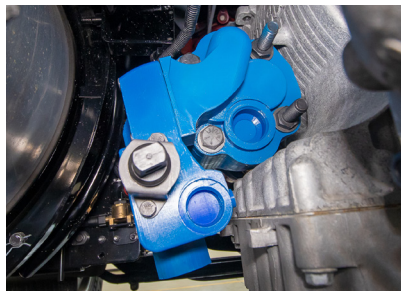

Rear View

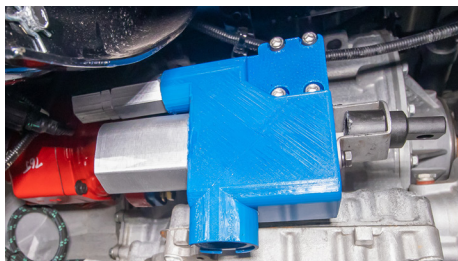

Kenworth - T880

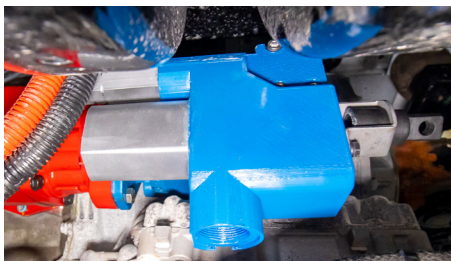
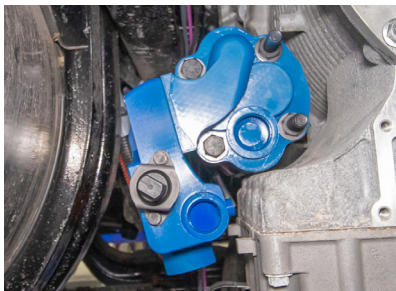

Peterbilt - 389

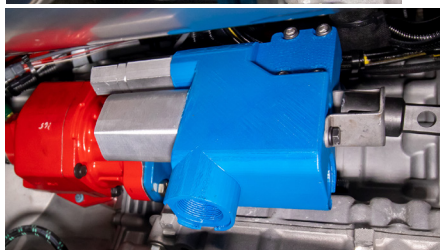

Western Star - 4700SF

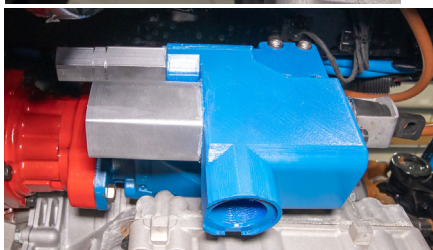

Permco is a leading manufacturer of high-pressure hydraulic gear/vane pumps and motors, flow dividers, intensifiers, and accessories. Available in a wide variety of sizes and configurations to suit your application needs.

**Our Online Support is available
24/7/365 for your needs!**

Email: support@permco.com

Call: (800) 626.2801



All product and company names are trademarks™ or registered® trademarks of their respective holders. Use of them does not imply any affiliation with or endorsement by them.

Permco USA | 1500 Frost Road | P. O. Box 2068 | Streetsboro, Ohio 44241

Bulletin # MVP-0220 Version 1.5



NFFA
Solutions through
motion technology



Member