

# PERMCO

# P257

## **257 SERIES PUMPS AND MOTORS**

**MEDIUM DISPLACEMENT SLEEVE BUSHING PUMPS AND MOTORS**



**P257 SERIES TANDEM  
SINGLE INLET/DUAL OUTLET**

### **257 SERIES FEATURES**

- Heavy duty sleeve bushing design in a medium frame size
- Cubic inch displacements from 1.29 through 6.43
- Working pressure up to 4500 PSI
- Speeds up to 2400 RPM
- Flows up to 65 GPM
- Doweled and high strength cast iron construction
- 100% factory tested
- High strength alloy steel gear and shaft sets
- A wide range of porting, mounting, and shaft options available
- Pressure balanced wear plates maintain high pump efficiency throughout all operating ranges
- Both single inlet/single outlet and single inlet/dual outlet bearing carriers available



**P257 SERIES SINGLE**



*The Sensible Choice*

# Dimensional Data (inches)

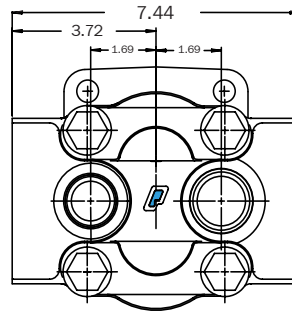
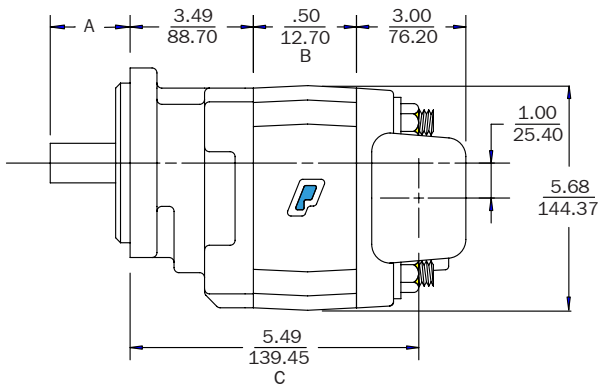

- A. See bushing series catalog for lengths and dimensions
- B. 0.50" plus gear width
- C. 5.49" plus gear width
- D. 10.85" plus total gear width

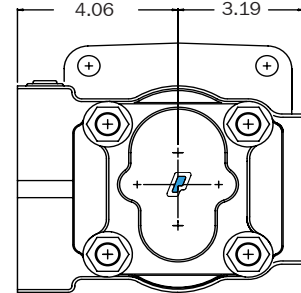
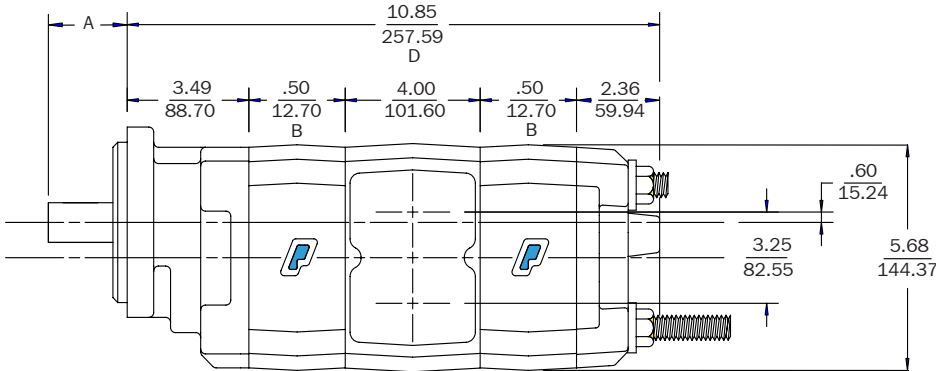

P257 Performance Chart/Specifications

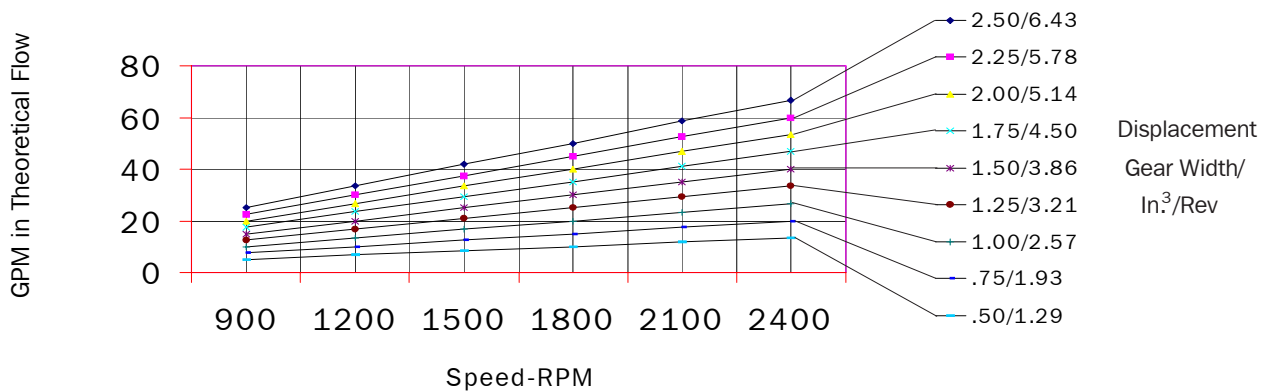

GEAR WIDTH (IN)	DISPL CU IN/CC	MAX RPM	MIN RPM	MAX PSI/BAR
0.50	1.29/21	2400	600	4500/310
0.75	1.93/32	2400	600	4500/310
1.00	2.57/42	2400	600	4500/310
1.25	3.21/53	2400	600	4500/310
1.50	3.86/63	2400	600	3500/241
1.75	4.50/74	2400	600	3250/224
2.00	5.14/84	2400	600	3000/207
2.25	5.78/95	2400	600	2750/190
2.50	6.43/105	2400	600	2500/172

Permco  
1500 Frost Rd.  
P. O. Box 2068  
Streetsboro, OH 44241  
Copyright © 2006 Permco

Phone 330-626-2801  
Fax 330-626-2805  
e-mail info@permco.com  
www.permco.com

Permco Hydraulik AG  
P. O. Box 553  
6343 Rotkreuz  
Switzerland  
e-mail heinzm@permco.com

Permco (TianJin) Hydraulics Inc., Ltd.  
236 Jinbindadao Free Trade Zone  
TianJin Port, China  
e-mail technic@permcotj.com  
www.permcotj.com © Bulletin #06-257A