



TECHNICAL SPECIFICATIONS



3700 SERIES

Large displacement roller bearing pump and motor



PUMP PERFORMANCE CHART [gpm]

GEAR WIDTH [in]

SPEED [rpm]	GEAR WIDTH [in]										
	1/2	3/4	1	1 1/4	1 1/2	1 3/4	2	2 1/4	2 1/2	2 3/4	3
600	—	—	—	—	—	—	—	—	—	—	—
900	—	—	—	—	—	—	—	—	—	—	—
1200	—	—	14.0	17.0	21.0	25.0	29.0	33.0	37.0	—	44.0
1500	—	—	18.0	22.0	27.0	32.0	37.0	42.0	47.0	—	55.0
1800	—	—	22.0	27.0	33.0	39.0	45.0	51.0	56.0	—	66.0
2100	—	—	26.0	32.0	39.0	46.0	52.0	60.0	66.0	—	78.0
2400	—	—	30.0	37.0	45.0	53.0	60.0	68.0	76.0	—	89.0
Max RPM	—	—	2400								
Displacement (in³)	—	—	1.54-9.26								
Displacement (cc)	—	—	25.2-151.7								
Max Operating PSI	—	—	2250								

SPECIFICATIONS

Series	Type	Frame Size	Displacement	Max RPM	GPM @ 1000RPM	Max PSI
3700	Bearing	Large	1.54-9.26	2000	6.5-40	2250

3700 SERIES

MOTOR PERFORMANCE CHART

GEAR WIDTH [in]

SPEED [rpm]	1			1 1/2			2			2 1/2			3		
	Input (GPM)	Output Torque (in-lb)	Output (HP)	Input (GPM)	Output Torque (in-lb)	Output (HP)	Input (GPM)	Output Torque (in-lb)	Output (GPM)	Input (GPM)	Output Torque (in-lb)	Output (GPM)	Input (GPM)	Output Torque (in-lb)	Output (GPM)
800	13.5	800	10	19.5	1270	16	26.5	1750	22	32	2240	28.5	37	2800	35.5
1000	16.5	790	12.5	23.5	1250	20	32	1720	27.5	39	2210	34	45	2780	43.5
1200	21.5	770	17	31.5	1210	26.5	42	1675	36	52	2180	47.5	61	2710	58.5
1800	27.5	710	20	40	1145	32.5	53	1595	45	65.5	2100	60	77	2560	73

DIMENSIONAL DATA

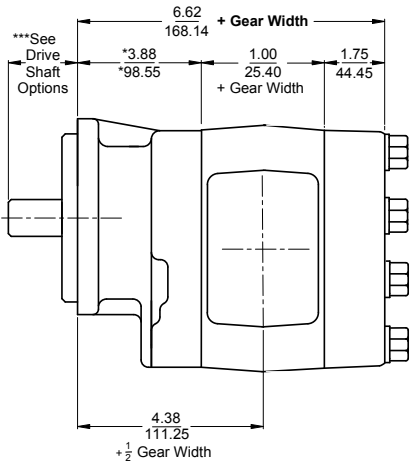

SINGLE UNIT

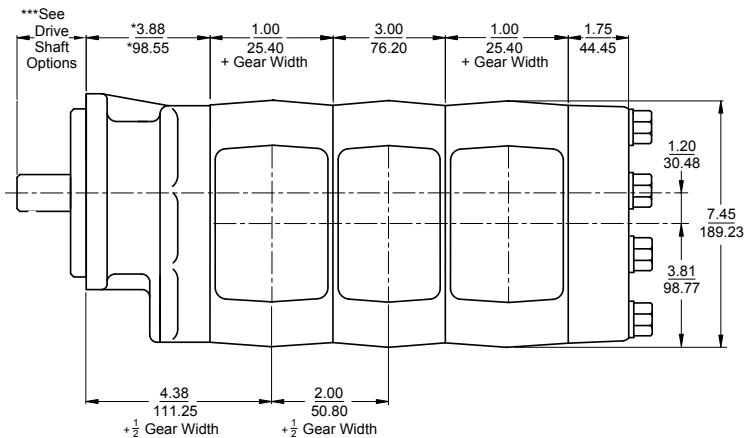

*For double bearing option, dimensions are 5.75 / 146.05 MULTIPLE UNIT

SINGLE UNIT

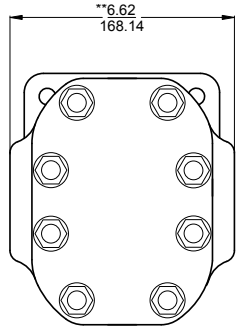

DISCLAIMER Consult your Permco Representative or the factory for operation below 600 or above 2400 RPM and temperatures above 180° F. Oil Viscosity: 150 SUS (32.1 cSt.) at 100° F (37.8° C) | Oil Temperature: 150° F (65.5° C)



1500 Frost Road P.O. Box 2068
 Streetsboro, Ohio 44241
 Phone 330.626.2801 • Fax 330.626.2805

support@permco.com • www.permco.com
 twitter: @permco
 facebook: www.facebook.com/permco